



## Maria's Pillow

Are you decorating your first home or want to add some flair to your family room? Here's an idea that won't damage your budget. This accent pillow can be created by recycling those forgotten items in your closet!

Skill Level: Beginner

### Supplies:

- Baby Lock Maria Sewing Machine
- 1 to 3 old sweaters or sweatshirts
- Fusible knit interfacing
- Iron and ironing board
- All-purpose thread to match
- 6 large buttons
- 1/8" ribbon
- Hand needle
- Tapestry needle with large eye
- Stuffing for pillow
- Scissors
- Pins

6. With the right sides of the 15" x 12" strips together, stitch the three sections together to form the pillow front piece.
7. Thread the tapestry needle with the ribbon. Tie a knot in the end of the ribbon. Sewing long stitches, stitch the ribbon through the sweater fabric covering the seam. Tie a knot at the end to secure.
8. Repeat for the other seam.

### Instructions:

1. Fuse three 6" x 13" pieces of interfacing to the wrong side of the sweater fabric (following the manufacturer's directions).
2. Cut three 5" x 12" strips from the interfaced section of the sweaters alternating the colors or the direction of the weave/texture of the fabric.
3. Then fuse one 16" x 13" piece of interfacing to the wrong side of the sweater fabric for the pillow back.
4. Cut one piece 15" x 12" for the pillow back from the previous interfaced sweater fabric.
5. Thread the Baby Lock Maria sewing machine with all-purpose thread.





## Maria's Pillow Continued

9. To sew the buttons by machine, attach the button sewing foot (Figure 1), place the pattern selector on C, and lower the feed dogs\* (Figure 2) on the machine.

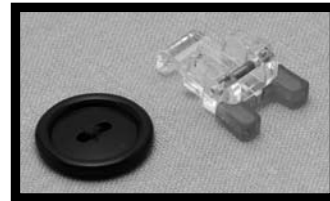

Fig. 1

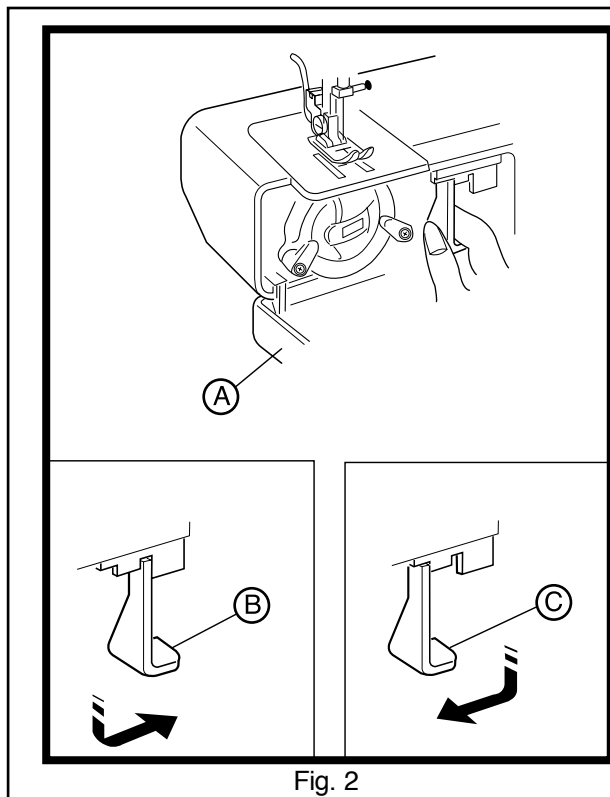

Fig. 2

### \* Lowering the Feed Dogs:

- (A) Open the bobbin cover.
- (B) To drop the feed dog, pull down the drop lever and move it to the right, as illustrated.
- (C) To raise the feed dog, pull down the drop lever and move it to the left, as illustrated.

10. Adjust the stitch width and turn the handwheel to check if the needle enters into each hole in the button. Lower the foot to hold the button in place. The holes in the button should align with the slot of the foot.
11. Stitch several times, repeat for remaining holes on a four-hole button.
12. Repeat this process until all six buttons are secure. Remember to raise the feed dog after sewing.
13. Pin the front to back piece with the right sides together. Using a straight stitch, stitch around the outer edge leaving an opening for stuffing.
14. Clip excess bulk and seam allowances from the corners.
15. Turn right side out. Stuff firmly.
16. Using a hand sewing needle and thread, stitch the opening closed.



**FOR THE LOVE OF SEWING**

For other exciting projects like this one, visit [www.totallystitchin.net](http://www.totallystitchin.net) and [www.babylock.com](http://www.babylock.com)